

Copyright: This document and all information contained herein is the sole property of Aysford Sansome. Reproduction in whole or in part is strictly forbidden and may not be issued to any third party for any purpose unless prior permission is obtained.

DO NOT SCALE THIS DRAWING
Contractor must verify all dimensions on site before commencing any work or preparing manufacturing drawings. If in doubt ask.

Base drawing from R.S. Coombs
Drawing no. 87/28

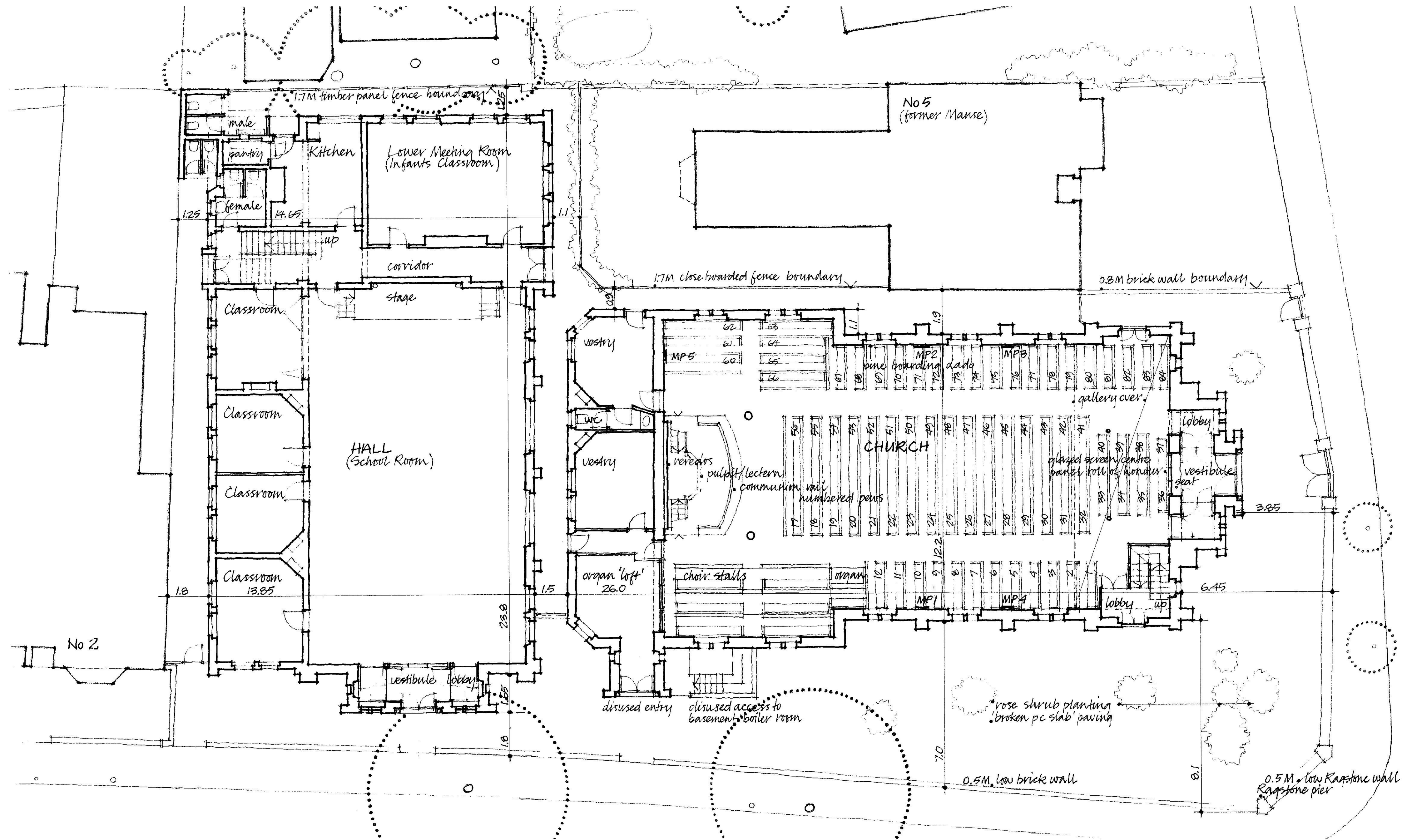

Rev Revision Note Date

Date Sept 2019 Scale 1:100 @A1

PLANNING

Project: Park Road Methodist Church
Church Conversion to Residential Units
Park Road
Southend-on-Sea

Title: Existing Ground Floor Plan

Draw No: 1716/T/002

Post: 6 Riverside House
Lower Southend Road
Wickford, SS11 8BB.
Tel: 01268 562266
Email: info@aysford.com

